

*The feedback you provide
helps to shape future projects*

We invite you to complete the
online feedback form to share
your thoughts.

SCAN THE QR CODE



OR VISIT:

salisbury.sa.gov.au/haveyoursay



8406 8222
city@salisbury.sa.gov.au

34 Church Street
Salisbury SA 5108

f t i
[@cityofsalisbury](https://www.instagram.com/cityofsalisbury)

salisbury.sa.gov.au

Have your say

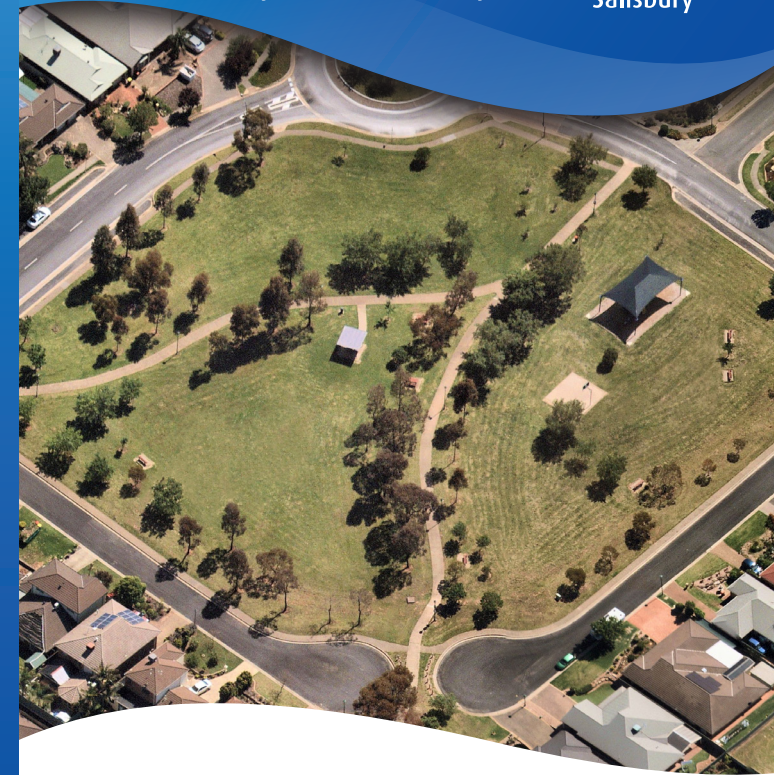

RM Williams Drive Reserve PLAYSPACE RENEWAL

You are invited to have your say on
this proposed playspace renewal.

Consultation Dates:
22 August to 4 September 2022

RM Williams Drive Reserve PLAYSPACE RENEWAL

The City of Salisbury is seeking feedback on how you and your family use and interact with the reserve playspace.

What do you like about it? What do you think could be better?

The feedback you provide will be presented to Council and used to inform planning and delivery of other Council playspace renewal projects.

Consultation Dates:
22 August to 4 September 2022

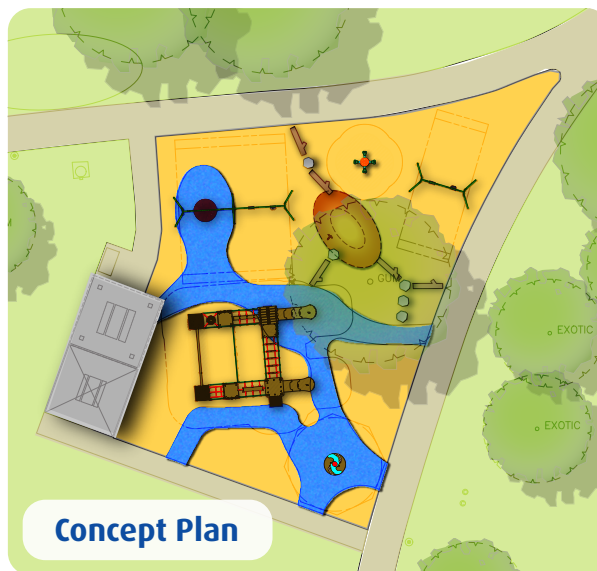

We invite you to complete the online survey to share your thoughts.

Share your thoughts at:
salisbury.sa.gov.au/haveyoursay

**Or scan the
QR code:**



The concept plan has a focus on nature and inclusive play with proposed features including:



1. Play tower with slides & track rider



2. Rocker



3. Spinning carousel



4. Swing sets



5. Rubber soft fall mounds



6. Talking tubes



7. Log and boulder steppers

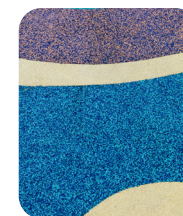

8. Rubber soft fall through play area



10. Shelter & picnic setting